

1. 燃油管路 - 检查

检查燃油系统管路和软管是否损坏、泄漏和老化。更换所有损坏的零件。

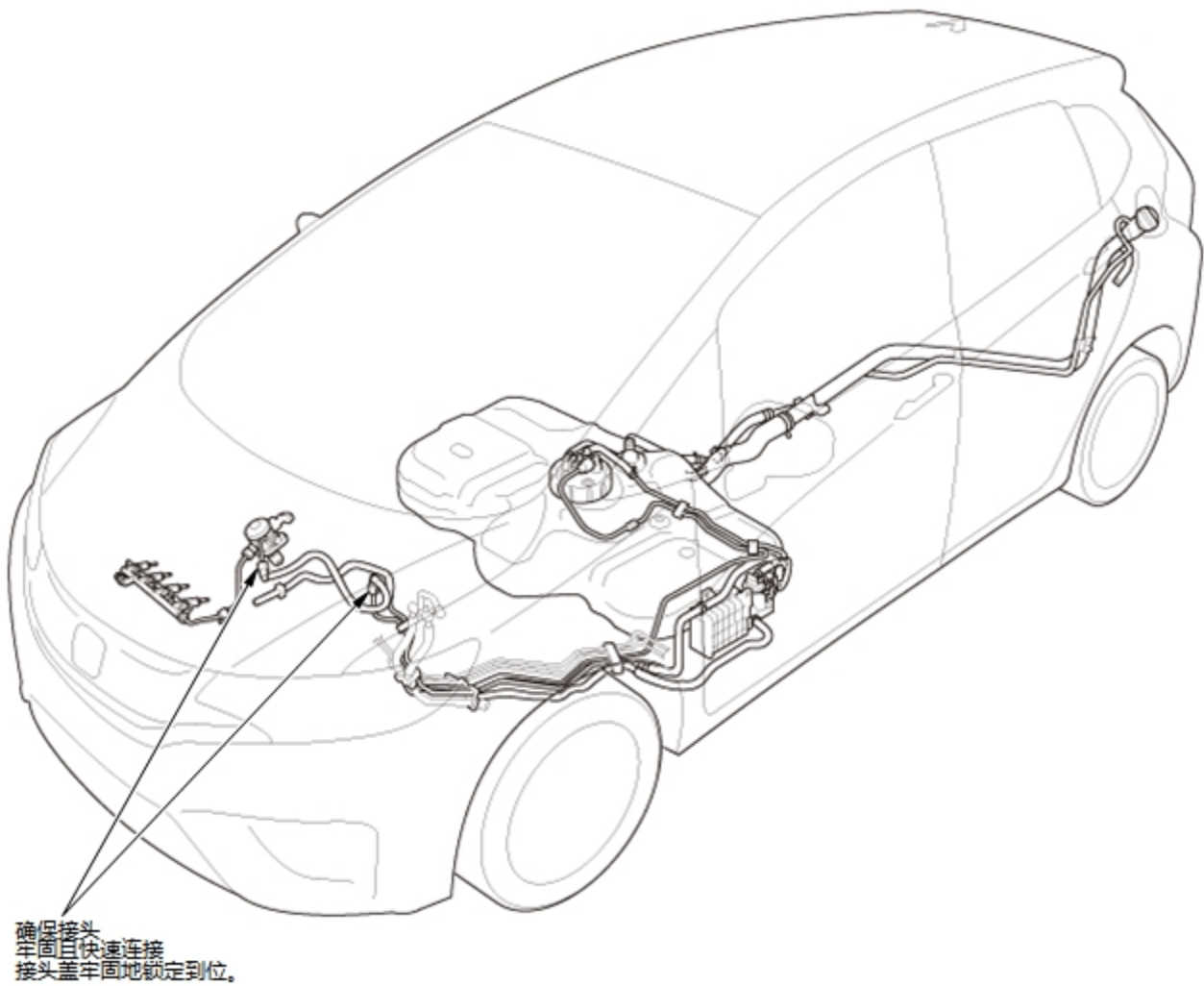

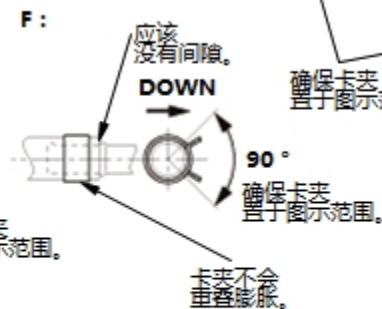

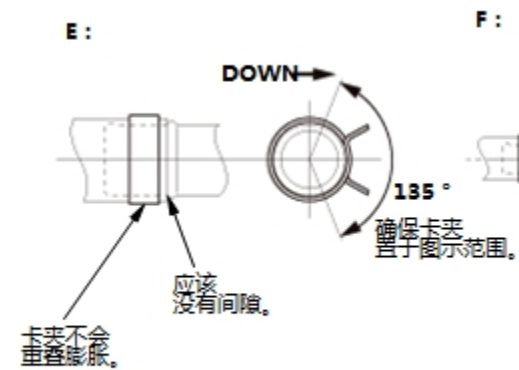
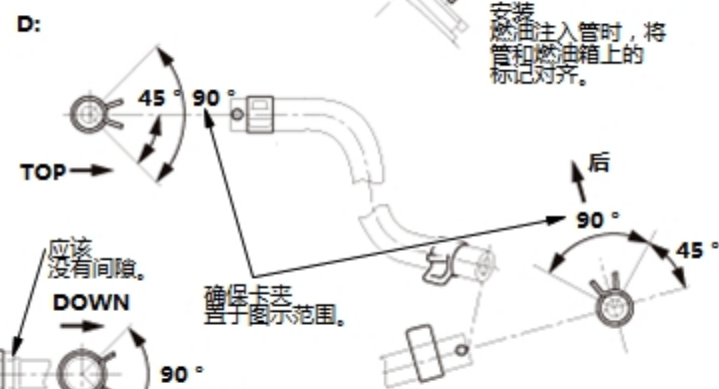
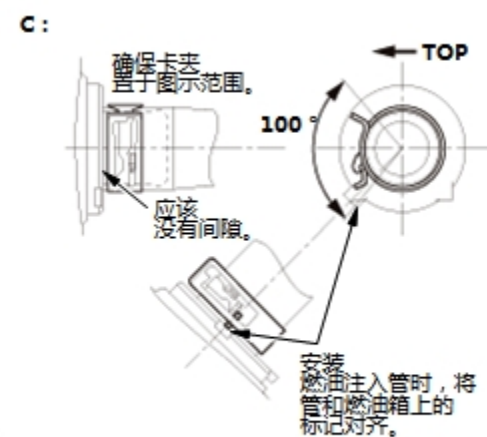
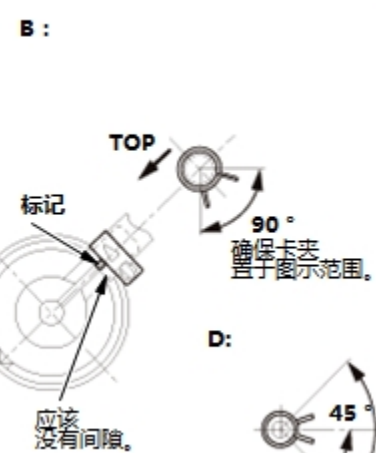
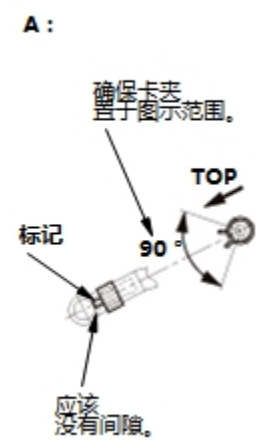
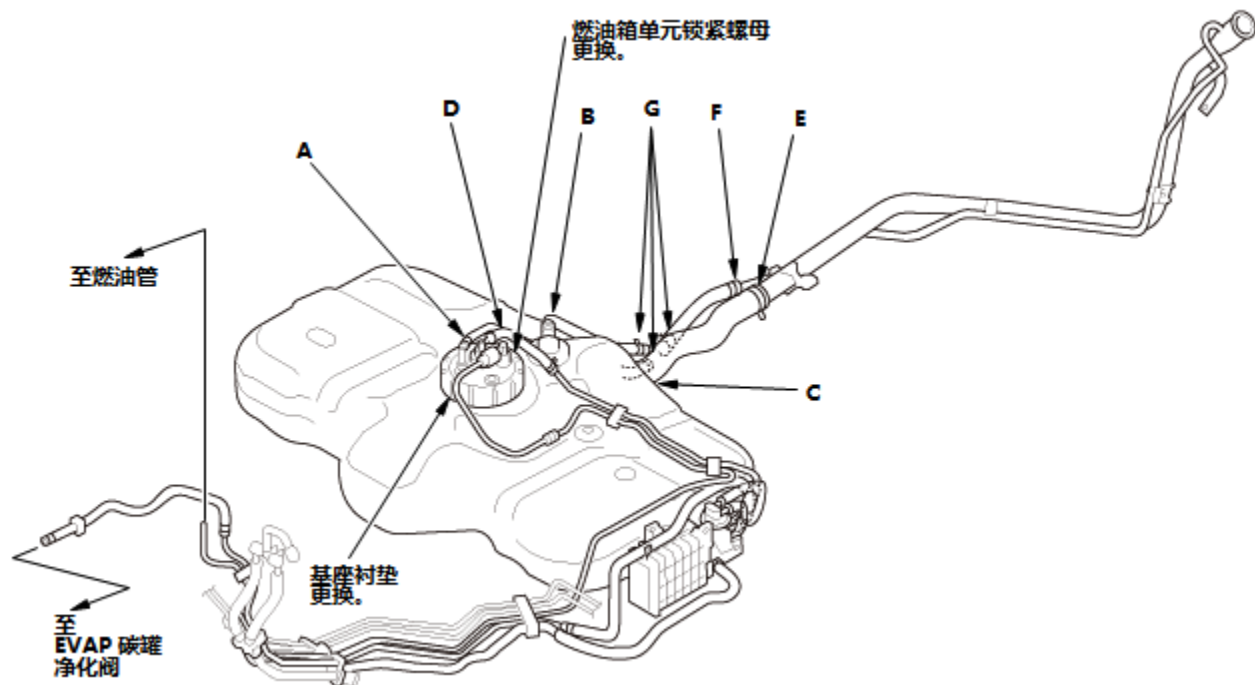
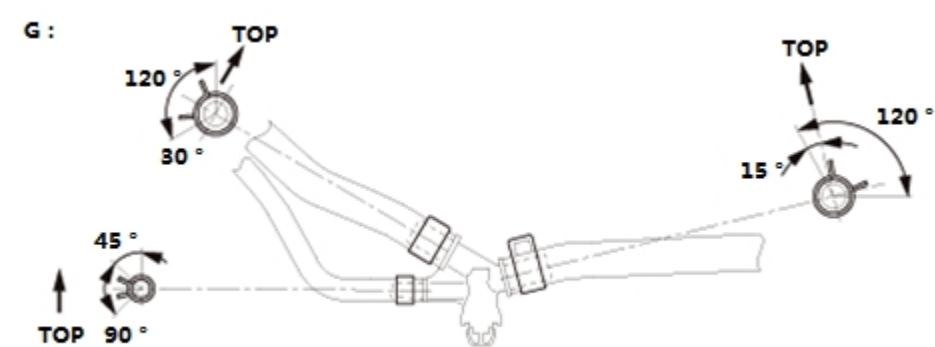

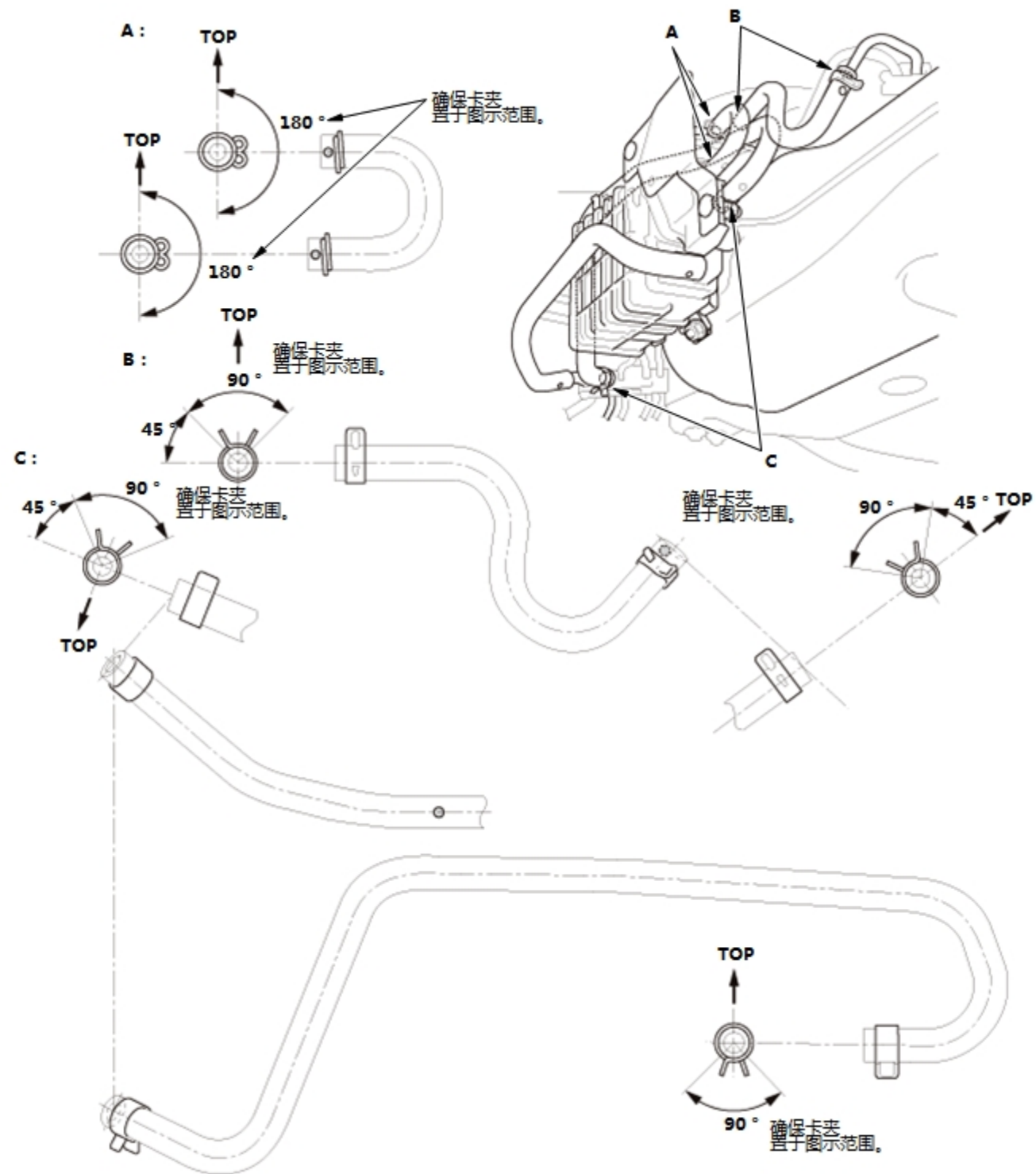

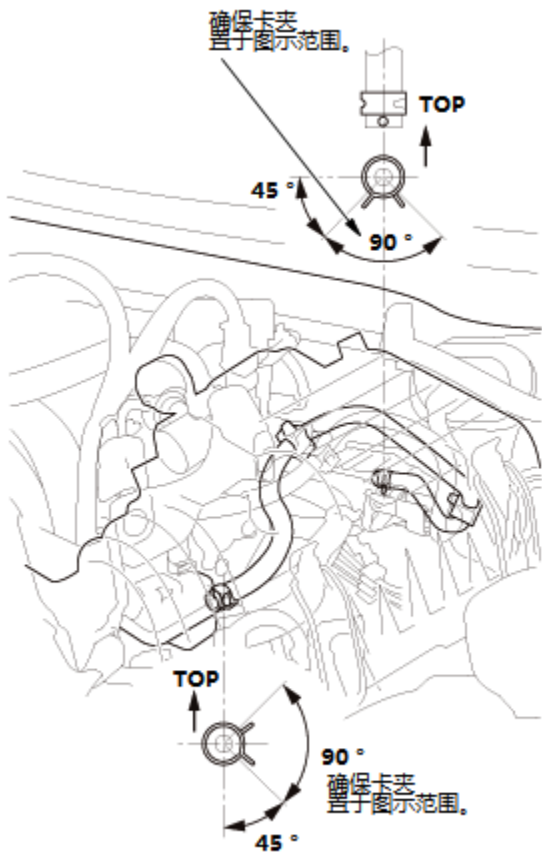

### 燃油泄漏检查

1. 高压燃油泵盖 - 拆卸



## 2. 燃油分配管盖 - 拆卸

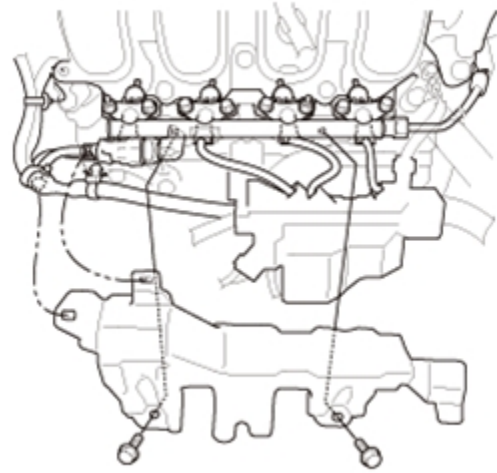

## 3. 燃油泄漏 - 检查

1. 将红色检修喷剂喷到喷油器接头 (A)、燃油管路 (B) 和高压燃油泵 (C) 上。将检漏仪 (Snap-on 可燃气体检漏仪) 固定到接头上。

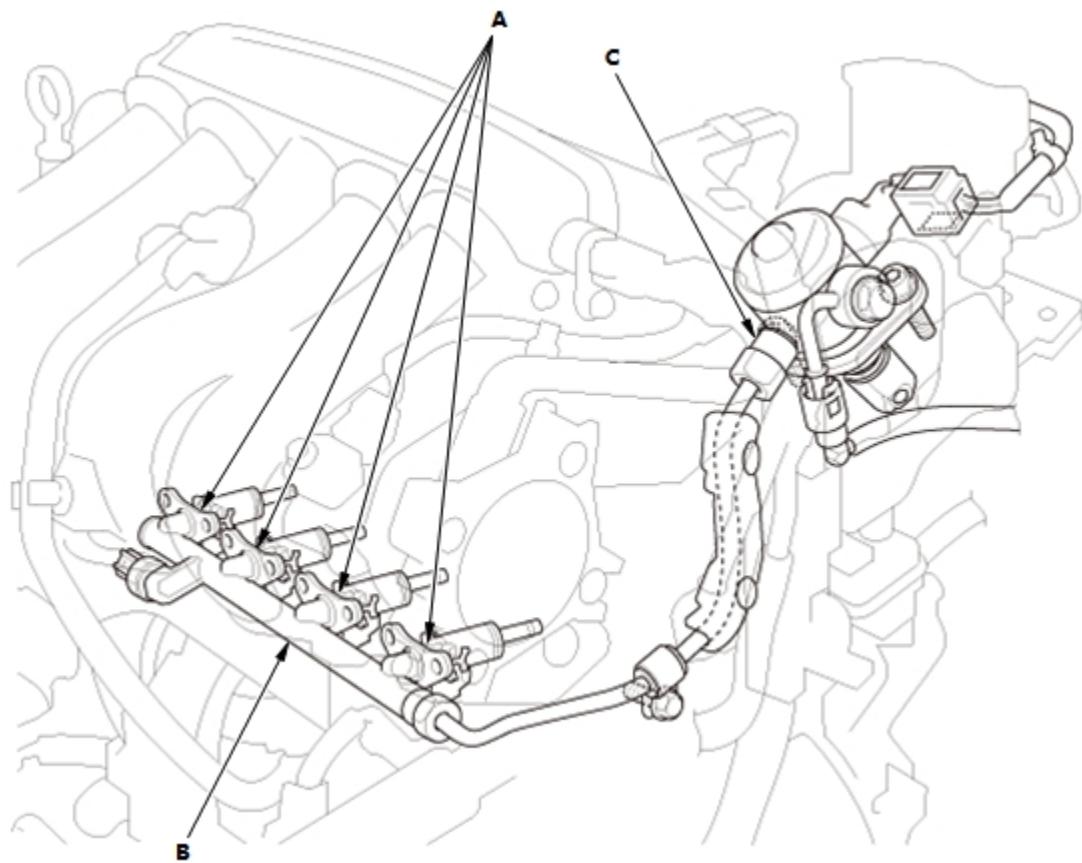

2. 将车辆转为 ON 模式，但不要启动发动机。燃油泵运转约 2 秒后，就会给低压燃油管路加压。重复此过程两到三次，然后检查

有无燃油泄漏。

- 3. 启动发动机。将发动机转速保持在  $3,500 \text{ min}^{-1} \text{ (rpm)}$  达 1 分钟，并熄灭发动机。
- 4. 检查喷油器接头、燃油分配管和高压燃油泵的是否有燃油泄漏。

4. 燃油分配管盖 - 安装

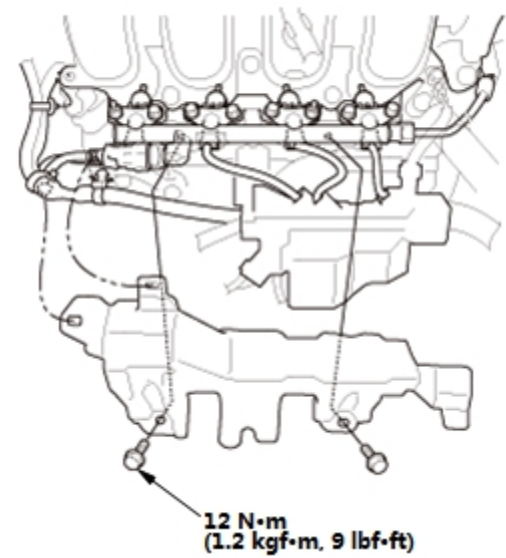

5. 高压燃油泵盖 - 安装

